

Site Address: Lands at Ballyoulster, Celbridge, Co. Kildare		
Applicant Name: Kieran Curtin, Receiver over certain assets of Maplewood Developments Unlimited Company (in liquidation and in receivership)		
Project Title: Ballyouster SHD (Phase 1)		
Drawing: SECTIONS 03, 04 & 05	Drawing Number: KDA - 08B	Scale: 1 to 100
Date: 06/2022	Bernard Seymour Landscape Architects 4 Mary's Abbey Dublin 7 t: +00 353 1 8747764 e: info@bslanarch.com	

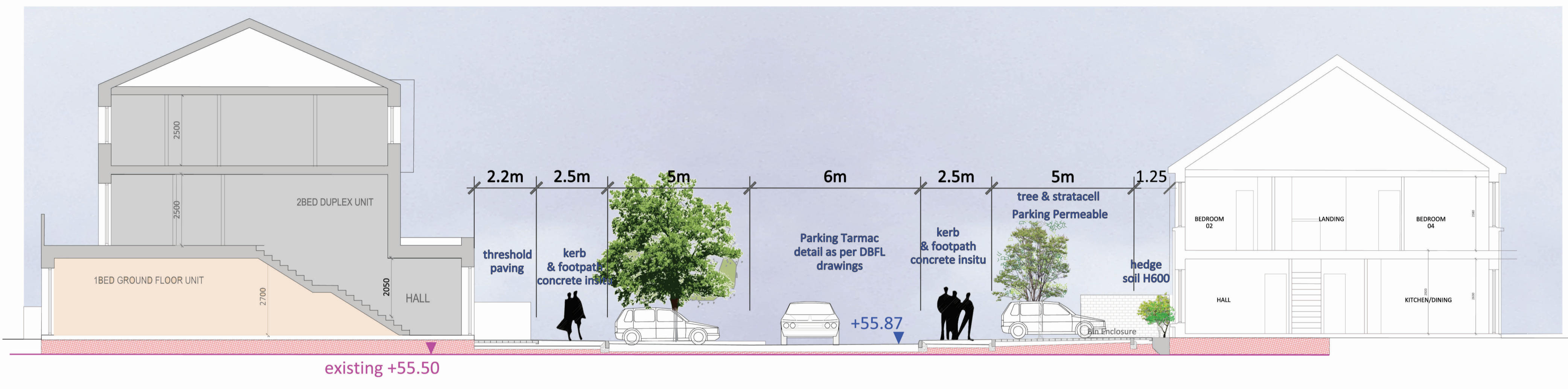

**SECTION 04**

FOR THE PAVING DETAILS AND BUILD-UP REFER TO PLAN **KDA-03-HARDLANDSCAPING&FURNITURE**  
 FOR ALL THE PLANTING DETAILS REFER TO PLAN **KDA-04B-PLANTINGPROPOSAL**.  
 FOR ALL THE DRAINAGE DETAILS AND LEVELS REFER TO **DBFL PLANS**.

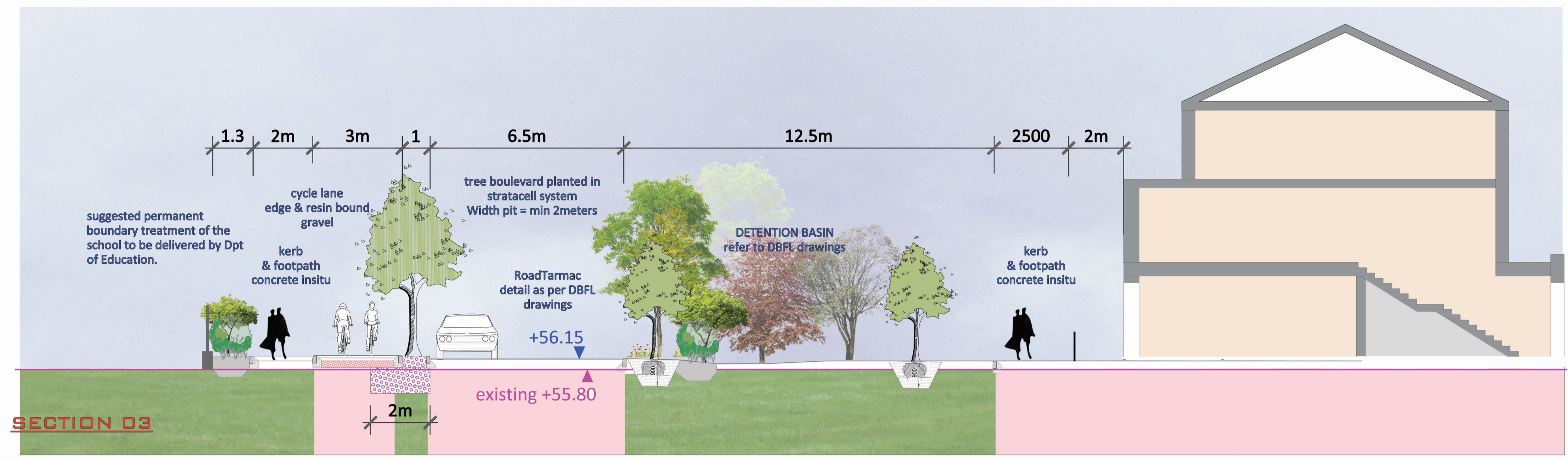
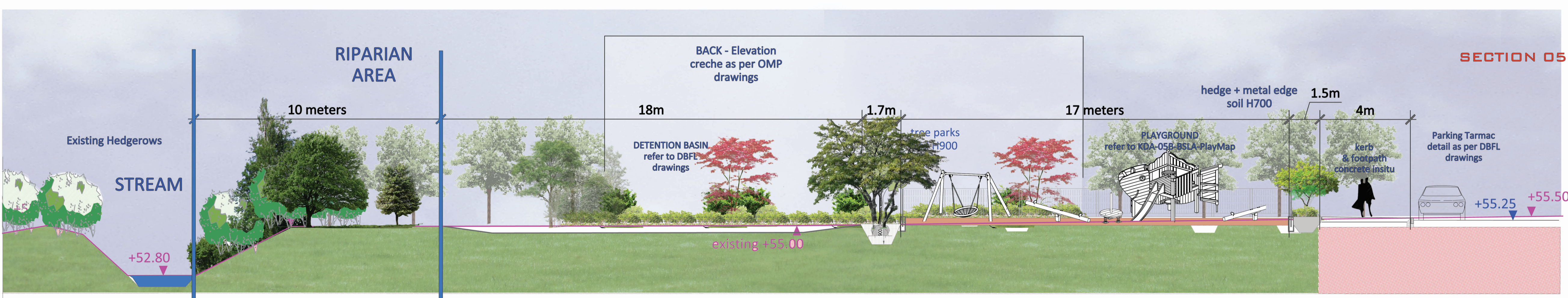

**SECTION 05**

